

REVOLVING DOOR

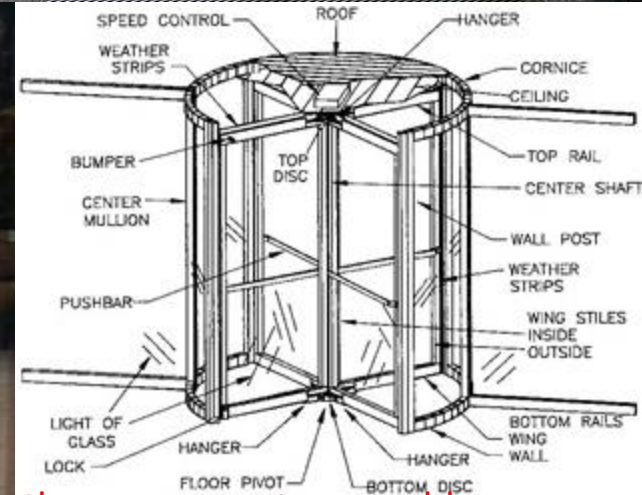

re·volv·ing door
an entrance to a large building
in which four partitions turn
about a central axis.
used to refer to a situation in
which the same events or problems recur
in a continuous cycle.
"many patients are trapped in a revolving door of admission, discharge,
and readmission"
a place or organization that people tend to enter and leave very
quickly.



ROLLER SHUTTER DOOR

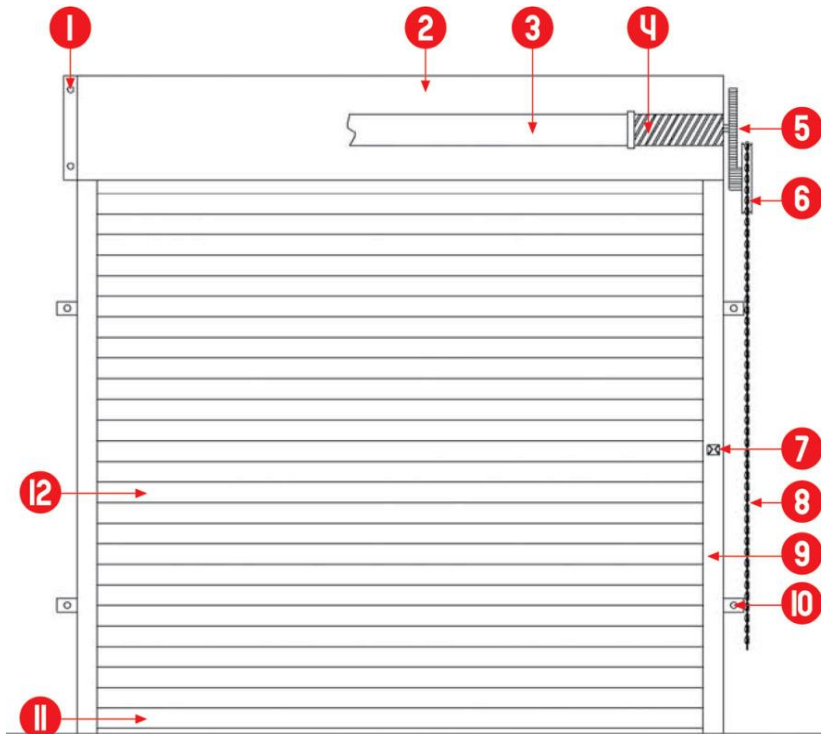

KEY.

- | | |
|-------------------------------------|-------------------------|
| 01. End Plates | 07. Chain locking keep |
| 02. Canopy cover (optional) | 08. Hand chain |
| 03. Barrel assembly | 09. Channel guide |
| 04. Helical coil springs (external) | 10. Fixing lugs |
| 05. Spur gear wheel | 11. T-bar (Bottom rail) |
| 06. Chain wheel | 12. Curtain |

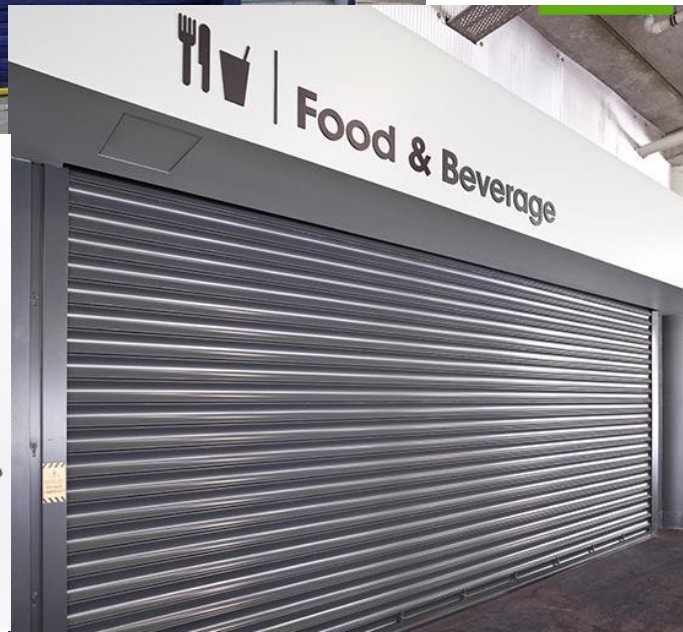

MILD STEEL Sheet DOOR



Product Description :Accurately designed and fabricated by our skilled and experienced professionals, our range of Mild Steel Swing Door Elevators consumes lesser energy, thereby reducing energy cost. Manufactured using superior quality components and raw material, these are appreciated for their minimum brake down calls, shorter waiting time & downtime. Installed with all safety standards, these elevators reflect the feature of safe operation.

Mild steel sheet doors:

The door frame is made up of angle or T-sections.

Shutter is made up of frame of angle of iron, having 2 verticals at least 3 horizontal.

Mild steel plates are welded to the shutter frame.

CORRUGATED STEEL SHEET DOORS



Corrugated steel sheet doors:

These are same as mild steel sheet doors, but in place of mild steel sheet corrugated steel sheet is welded.

HOLLOW METAL DOORS



Hollow metal doors:

Hollow steel sections are used to make these doors. The rails and stiles etc., are strengthened by welding small T or I sections inside.

HOLLOW METAL DOOR

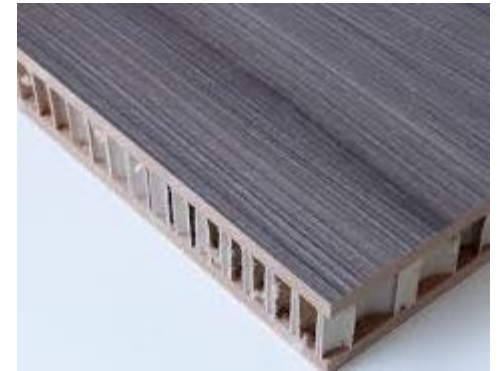
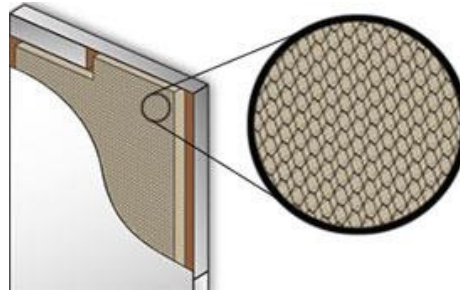
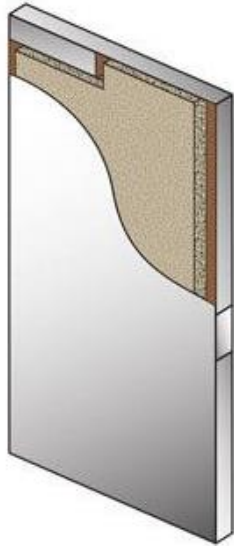

Honeycomb Core



F

G

FG

FG2

FL

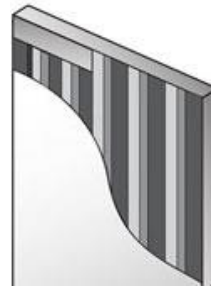

Steel Stiffened

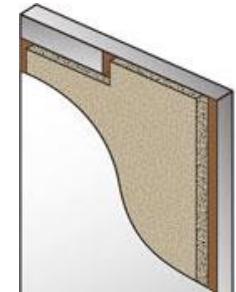

Polystyrene Core



Hollow Metal Door

Hollow Metal Door Features & Options

Galvanneal Coating

- Galvanneal steel is produced on a continuous hot-dipped galvanized steel line. Galvanneal steel provides an excellent surface for finish painting. Only a wipe down of the surface with mineral spirits is required before painting, a prime coat is not required.

Fire Rating

- Hollow metal doors and frames are fire rated for 45 minute, 1-1/2 hour, and 3 hour. Sidelite frames and borrowed lites can be custom manufactured to meet 45 minute fire rating.



Special Services

- Special hinge templating
- Door lites
- Special lock preparation
- E-channels for electric lock applications
- Flush bolt preparations

Honeycomb Core

- Rigid & impact resistant
- Resin impregnated
- Estimated STC 20 sound rating
- 20 gauge corrugated material

Insulated Core

- Steel doors are available insulated. They are insulated with Polystyrene with an R rating of 6.3 or Polyurethane with an R rating of 11.

Door Frames

- Prepared for 9/32" silencer holes
- 18 gauge galvanneal steel
- For use with 1-3/4" doors
- All jams complete with base and center strap anchors and an adjustable top tension anchor

METAL COVERED PLYWOOD DOORS



Metal covered plywood doors

This type of door is a composite construction of hollow metal door and wood door.

The door is encased in tight fitting sheet metal, having tightly folded joints to exclude air so that the core of the door does not ignite. So, it acts as fire proof.



FIXED WINDOWS

A window that cannot be opened, whose function is limited to allowing light to enter. This type of window is used in situations where light or vision alone is needed as no ventilation is possible through fixed windows



PIVOTED WINDOW

- A window having a section which is pivoted near the center so that the top of the section swings in and the bottom swings out.



DOUBLE HUNG WINDOWS

- A window with two parts that overlap slightly and slide up and down inside the frame. The two parts are not necessarily the same size.

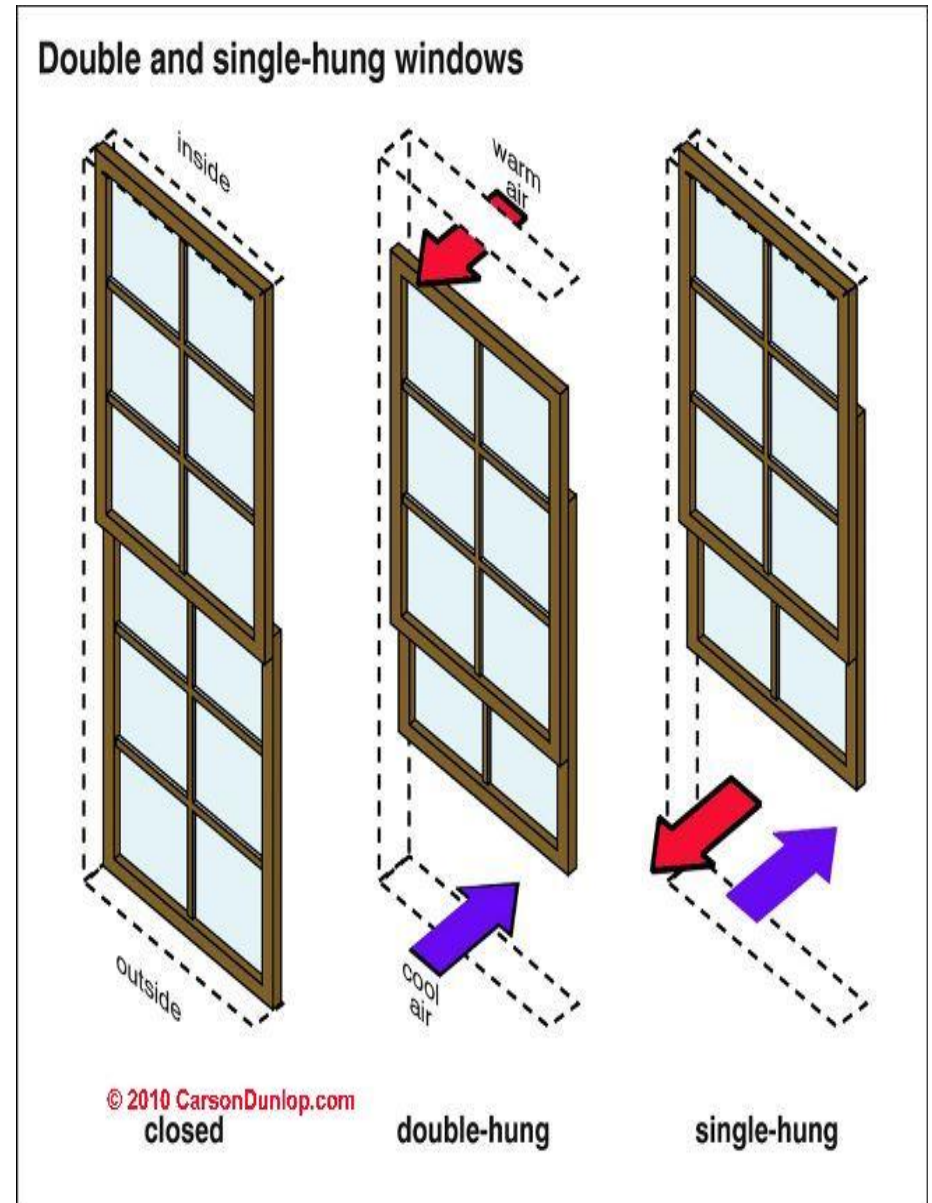

SLIDING WINDOWS



Their shutters
move
horizontally.

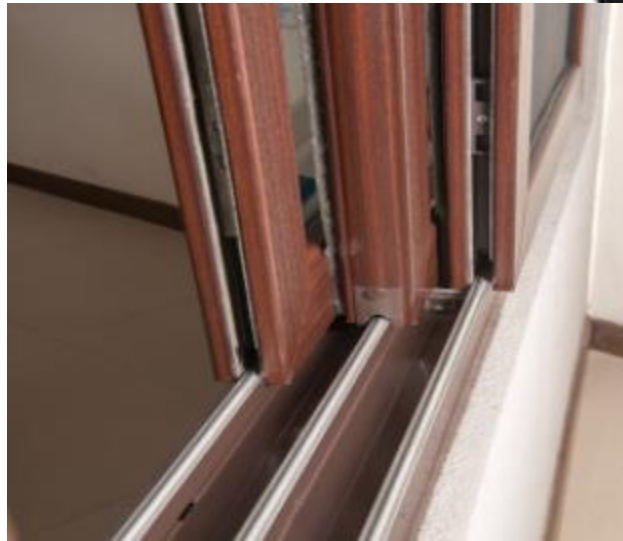

CASEMENT WINDOW

- A **casement window** to its frame by one or more hinges. They are used singly or in pairs within a common frame.



LOUVRED WINDOW

- A **louver** is a window, blind with horizontal slats that are angled to admit light and air, but to keep out rain, direct sunshine, and noise. The angle of the slats may be adjustable, usually in blinds and windows, or fixed.



BAY WINDOW

- A multi-panel window, with at least three panels set at different angles to create a protrusion from the wall line.

